

**FAST LAUNCH / PILOT BOAT**
**WILLFREEDOM**

This specification booklet is for guidance only. Whilst every care is taken in the preparation of this specification, please check details before making any decisions reliant upon them. For detailed information in respect of loading and stability please consult the approved stability booklet.

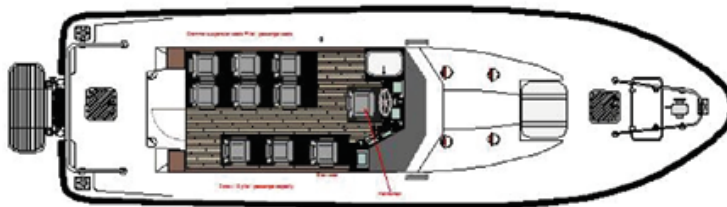

## FAST LAUNCH / PILOT BOAT

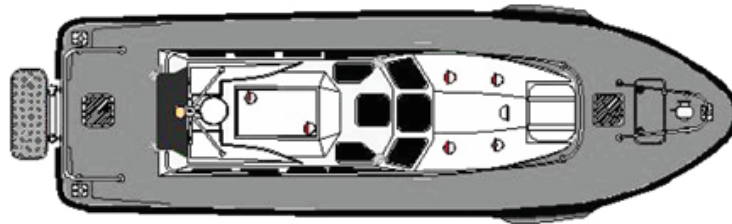

### GENERAL

<b>Type of Vessel</b>	Fast Launch / Pilot Boat - Interceptor 48
<b>Builder</b>	Safehaven Marine
<b>Build Date, Place</b>	2022, Ireland
<b>Classification</b>	MCA Workboat Code Cat 2 (60 miles) 10 pax MCA Cat 2 Pilot Boat

### DIMENSIONS

<b>Length O.A.</b>	14.9m
<b>Beam O.A.</b>	4.4m
<b>Draft Aft</b>	1.32m

### PERFORMANCE

<b>Free Running Speed</b>	26 Knots
---------------------------	----------

### PROPULSION SYSTEM

<b>Main Engines</b>	2 x Scania D113 070M
<b>Total Power</b>	1000hp
<b>Marine Transmissions</b>	S x ZF400 1.5:1
<b>Propulsion</b>	2 x 4 blade FPP Hypeform design

### AUXILLIARY EQUIPMENT

<b>Generator Sets</b>	Paguro SC Generator – 6.5Kw @ 1500rpm
<b>Electrical System</b>	24v DC and 220V Shore Supply

## WILLFREEDOM

### DECK EQUIPMENT

<b>Pilot Rail</b>	Hadrian Safety Rail
-------------------	---------------------

### ACCOMMODATION

<b>Main Cabin</b>	Suspension seats 2 crew/8 passengers
<b>F'ard Cabin</b>	6 persons Fully air-conditioned

### NAVIGATION & COMMUNICATION EQUIPMENT

<b>Searchlight</b>	Seematz
<b>Compass</b>	Magnetic and satellite
<b>Displays</b>	2 x Raymarine E70373 Axiom 12 Pro S Hybrid Displays
<b>Radar</b>	Raymarine T70408 4Kw 4ft open array
<b>GPS</b>	Raymarine T70327 Raystar
<b>Sonar</b>	Raymarine E70511 Realvision Sonar
<b>VHF</b>	Icom M506E DSC VHF Icom M330GE DVS VHF
<b>Hailer</b>	Furuno LH3000 Loud Hailer
<b>Handheld VHF</b>	2 x Icom with DSC
<b>Chart Plotter</b>	PC Based Seapro
<b>AIS</b>	Raymarine
<b>Thermal Imaging Camera</b>	Flir M232 Pan and tilt
<b>EPIRB/Radar Reflector</b>	